

IN9 SERIES – NATATORIUM

## IMPORTANT SAFEGUARDS

When using electrical equipment, basic safety precautions should always be followed, including the following:

THIS PRODUCT MUST BE INSTALLED IN ACCORDANCE WITH THE APPLICABLE INSTALLATION CODE BY A PERSON FAMILIAR WITH THE CONSTRUCTION AND OPERATION OF THE PRODUCT AND THE HAZARDS INVOLVED. DISCONNECT POWER TO ALL CIRCUITS BEFORE WIRING FIXTURE. INSTALL IN ACCORDANCE WITH ALL NATIONAL, STATE, AND LOCAL CODES. DO NOT CONNECT TO AN UNGROUNDED SUPPLY. READ ALL FIXTURE MARKINGS AND LABELS TO ENSURE CORRECT INSTALLATION OF FIXTURE. SUPPLEMENTAL INSTRUCTIONS MAY BE LOCATED ON THE FIXTURE, IN ADDITION TO THIS INSTRUCTION SHEET, REGARDING ORIENTATION, OR MOUNTING RESTRICTIONS.

## SAVE THESE INSTRUCTIONS

**!! FIXTURE IS DESIGNED FOR USE AS INDIRECT LIGHTING SOLUTION ONLY !!**  
**!! ANY OTHER USE WILL VOID ALL WARRANTIES AND MAY RESULT IN UNSAFE CONDITIONS !!**

## WALL MOUNT INSTALLATION

1. Disconnect facility power to the electric power supply leads.
2. Un-carton wall mount bracket(s).
3. Place wall mount bracket(s) over an installed electrical junction box. Locate and drill (4) pilot holes in mounting surface using bracket as template. Using 1/4-20 fasteners and anchors appropriate for the mounting surface (not supplied), mount bracket to surface.

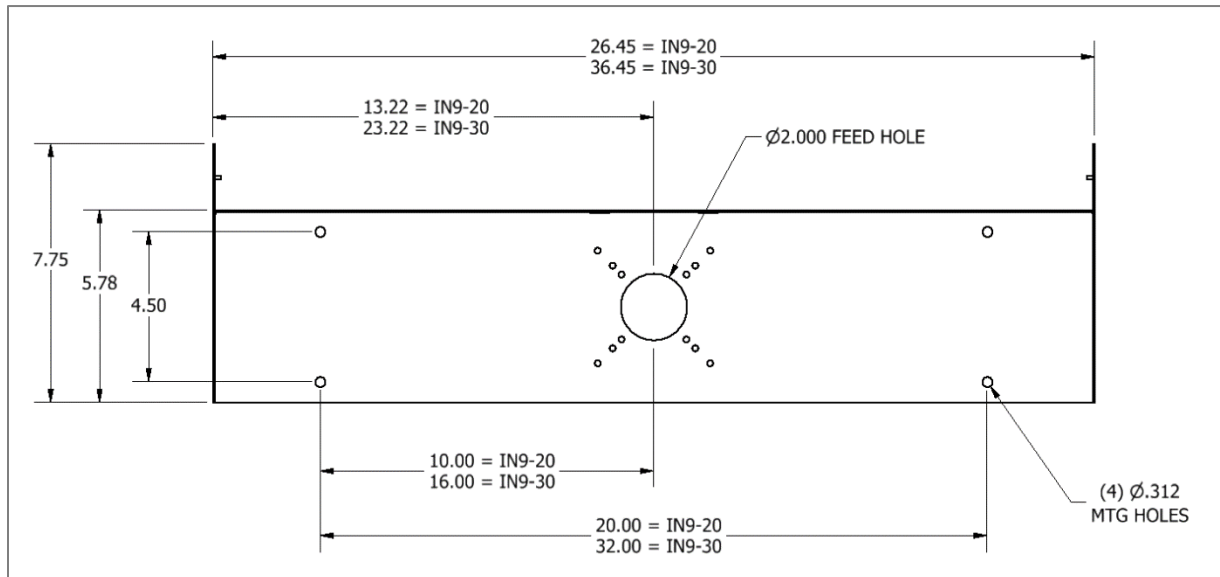

4. Un-carton fixture(s).
5. Remove hub endcaps at both ends of fixture. If needed, rotate hubs so that both hubs have indicator mark (slot) in the 'up' position.
6. Review aiming indicator marks on endcap of fixture to verify orientation/rotational range of fixture before lifting into place (reference picture in step 8 below).



7. **This step may require (2) people for safety:** Lift fixture into mounting bracket; while placing fixture in mounting arm slots, pull back slightly on each arm allowing pin to pop into hole in hub.

(fixture shown with optional cutoff shield)

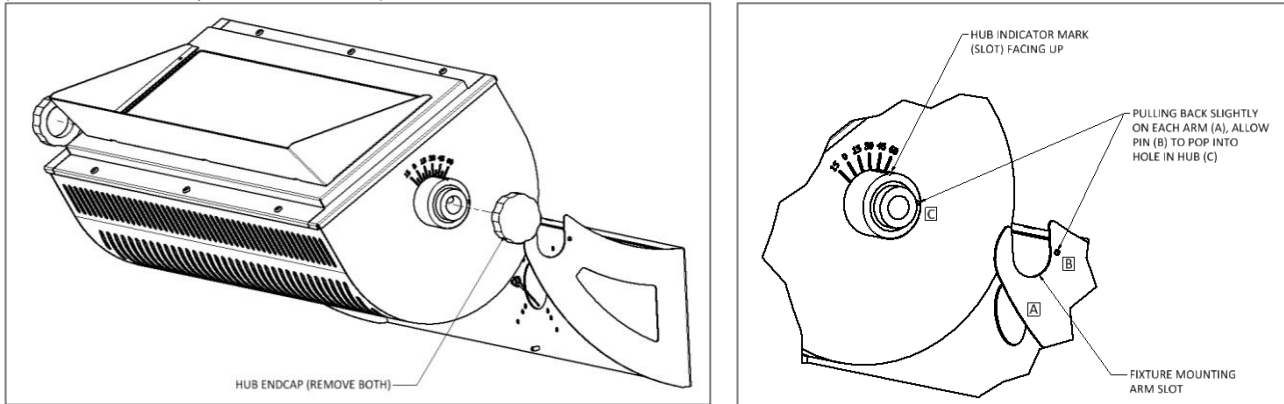

8. Reinstall hub endcaps; adjust fixture to angle required (determined by lighting designer for optimal illumination performance) using hashmarks on end of fixture and indicator mark/slot on hub. Secure in place by tightening hub endcaps.

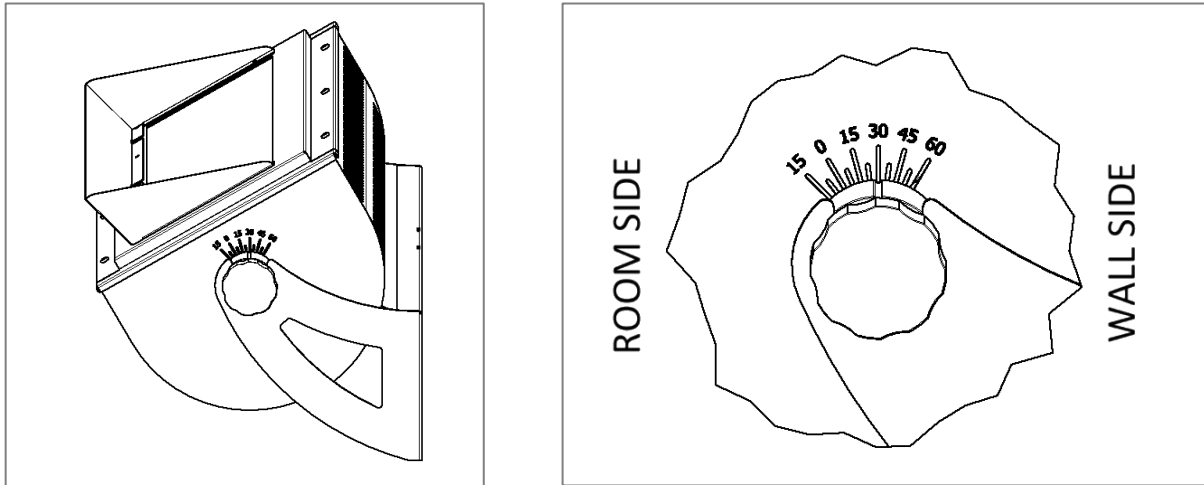

9. Remove hex nut and cover plate from wall mount bracket.  
10. Install cord + strain-relief through hole in cover and using large hex nut (supplied), secure to cover. Make electrical wiring connections from wired cover plate to AC supply, earth ground, and 0-10V dimming (if used) following all applicable electric codes.  
11. Secure wired cover plate to wall mount bracket by inserting tabs in top of bracket and re-installing hex nut.

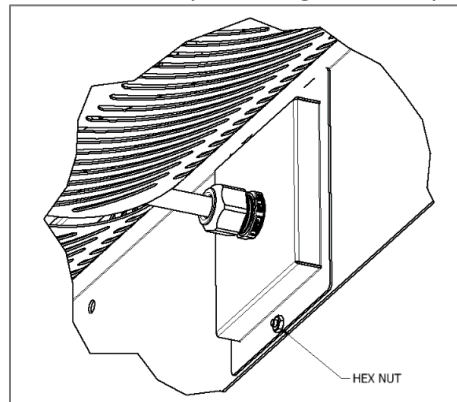

## PENDANT MOUNT INSTALLATION

### SAFETY RECOMMENDATION:

**A 1/16" or larger diameter safety aircraft cable (not included, or optionally included as SCH option) is recommended for attaching the fixture to a building structural member as supplemental support only. Consult local codes for details regarding approved safety cable methods and materials.**

1. Disconnect facility power to the electric power supply leads.
2. Un-carton pendant canopy assembly. Remove canopy cover from ceiling mounting bracket and place cover in secure location. Remove screw lock-up taped to bracket and place with canopy cover.
3. Install bracket so that side labelled "A-SIDE" is closest to the area to be illuminated. *NOTE: Sloped ceiling mounting has maximum 4:12 pitch.* Place ceiling mount bracket(s) at desired location; mounting over an installed electrical junction box not required if surface conduit (3/4" conduit) will be used. Locate and drill minimum (6) pilot holes in mounting surface using bracket as template. Using 1/4-20 fasteners and anchors appropriate for the mounting surface (not supplied), mount bracket to ceiling surface.

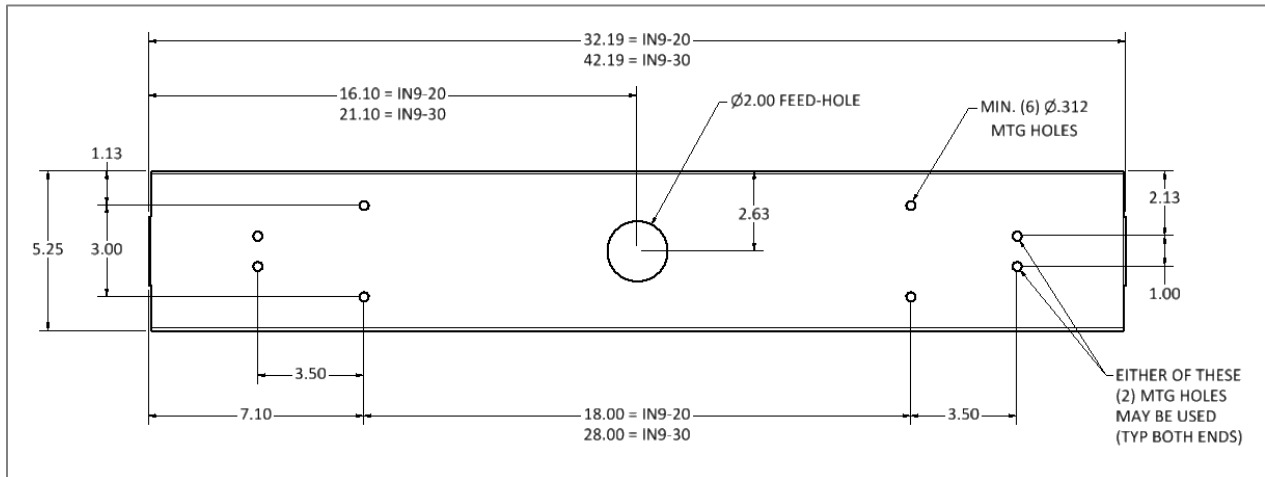

### MOUNTING BRACKET ORIENTATION EXAMPLES

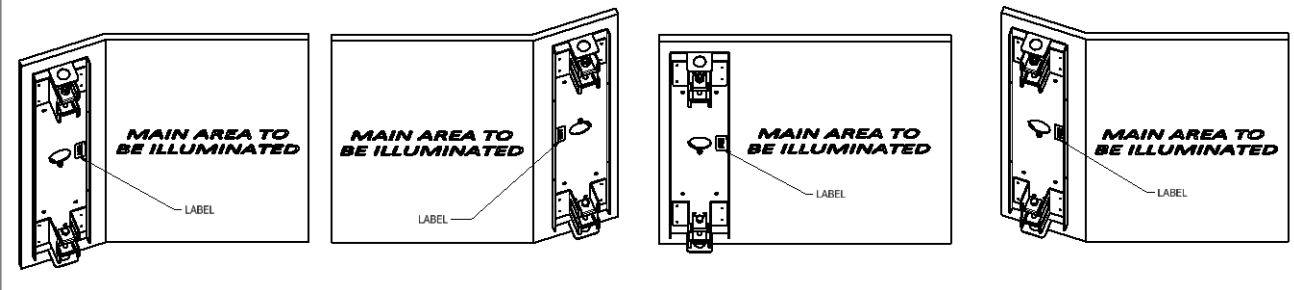

4. CANOPY COVERS:

*If installing on a flat ceiling:* remove center pull-out tabs from face of canopy cover (forming a round opening).

*If installing on a sloped ceiling:* remove pull-out tabs as indicated below.

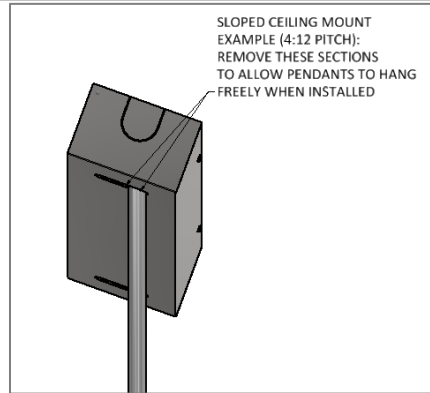
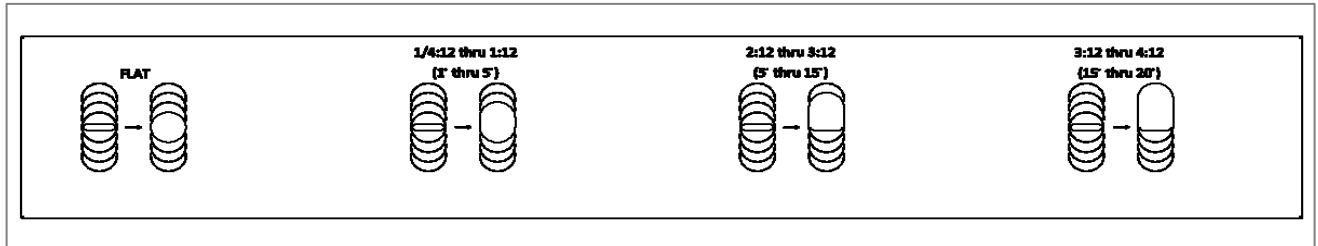

5. Un-carton pendants and fixture(s).

6. Place fixture on a flat, stable, and clean surface with door/lens opening perpendicular to surface. Place canopy cover on door side of fixture, in-line with fixture. Feed pendants (end without hook bracket) through openings in canopy cover and assemble pendants to fixture hubs. If needed, rotate pendants so that “hook” of bracket at top of pendants is parallel to surface. Feed power cord through appropriate pendant. If SCH option has been ordered: unwrap cable and feed cable through each pendant. Slide canopy cover toward fixture and allow to gently rest on fixture.

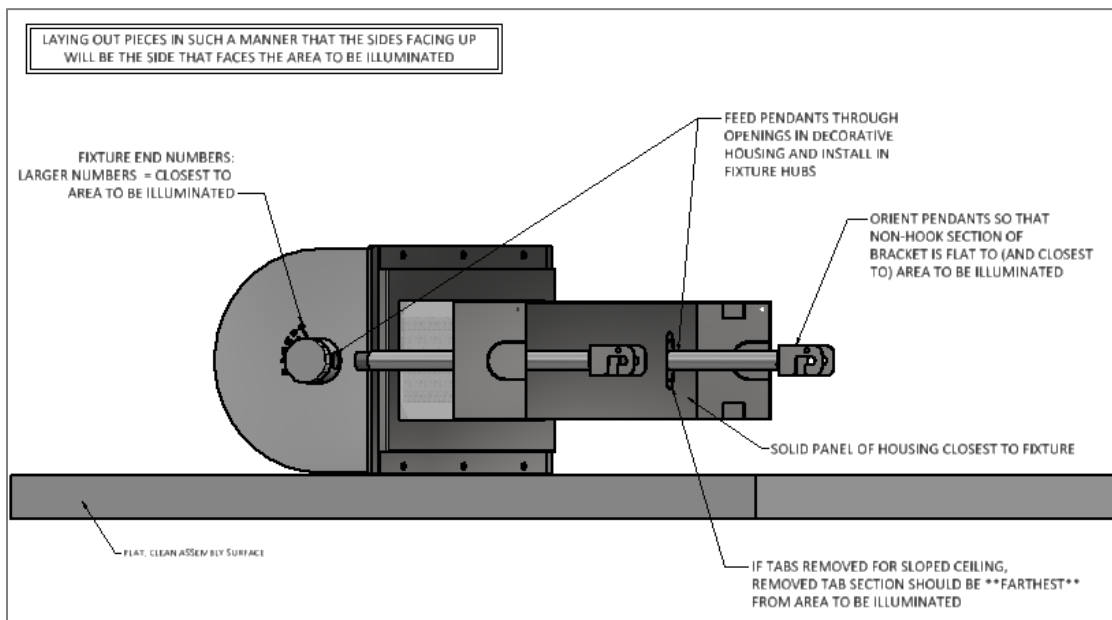

7. **For safety, this step should be performed by minimum (2) people:** Lift fixture up to mounting location with pendants pointing up. Using the bracket at the top of the pendants, “hook” over bolt in pendant mounting bracket. Make sure that cord is not pinched. If SCH option ordered – make sure that safety cables are not pinched.

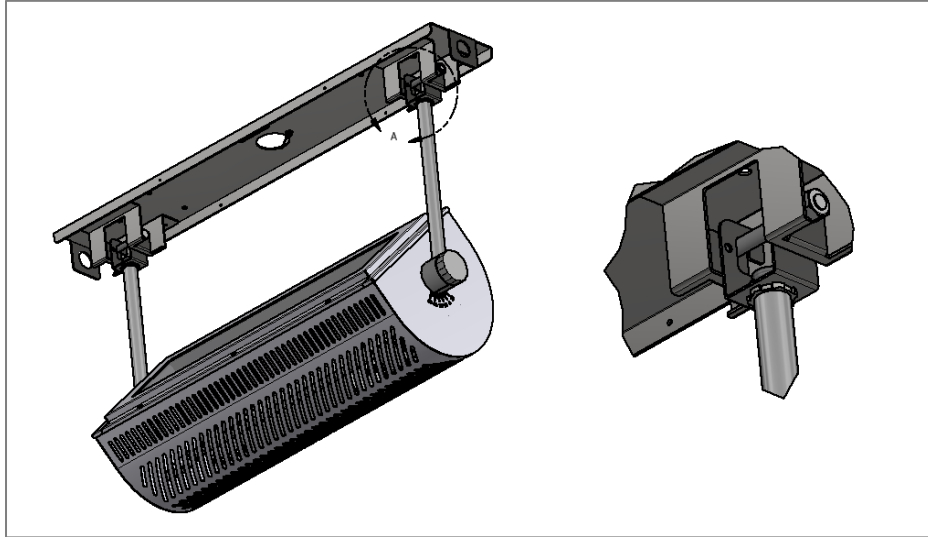

8. If SCH option ordered: Route free end of cable to building structure and securing using a site approved method.
9. If surface conduit is to be used: Attach conduit fitting(s) as needed to mounting bracket. Remove pull out section at end(s) of decorative cover as needed.
10. Make electrical wiring connections from cord to AC supply, earth ground, and 0-10V dimming (if used) following all applicable electric codes.
12. Lift canopy cover into place and secure to mounting bracket using 8-32 screws provided in lock-up.
13. Loosen hub endcaps; adjust fixture to angle required (determined by lighting designer for optimal illumination performance) using hashmarks on end of fixture and indicator mark/slot on hub. Tighten hub endcaps to secure fixture in place.

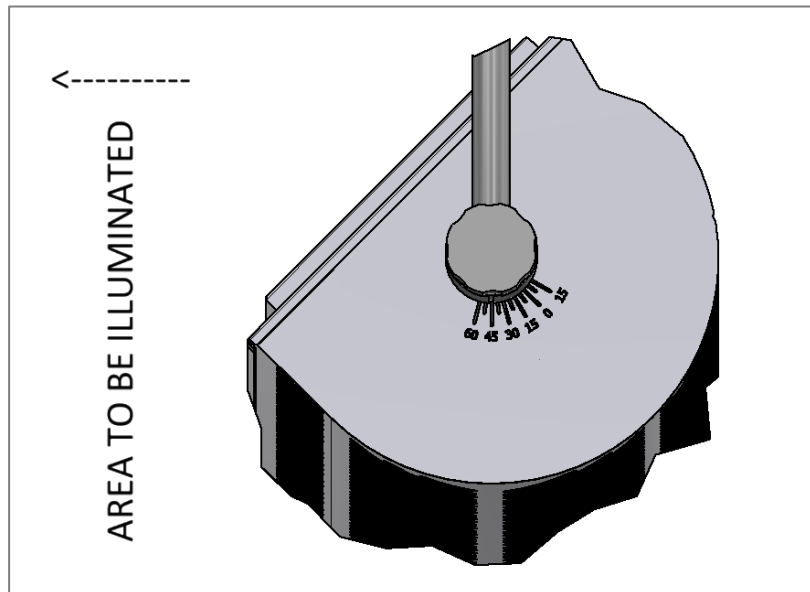
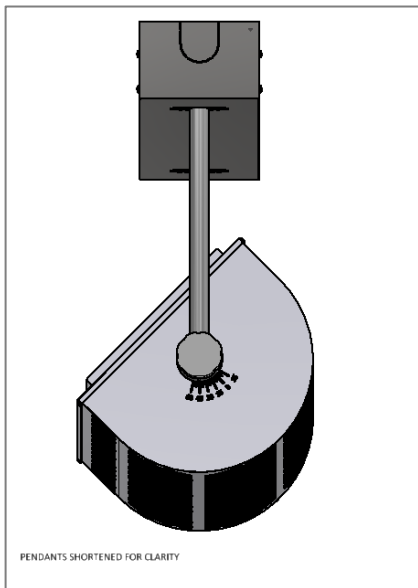

## MAINTENANCE, CARE, AND CLEANING GUIDE

**DISCONNECT POWER TO ALL CIRCUITS BEFORE SERVICING FIXTURE(S).  
QUALIFIED PERSONNEL SHOULD PERFORM ANY SERVICING OF FIXTURE(S).**

**!! FIXTURE IS DESIGNED FOR USE AS INDIRECT LIGHTING SOLUTION ONLY !!  
!! ANY OTHER USE WILL VOID ALL WARRANTIES AND MAY RESULT IN UNSAFE CONDITIONS !!**

*It is important that these lighting fixture(s) be installed and operated in a natatorium environment that is maintained and operated within industry standards including, but not limited to: ventilation, humidity levels, ambient and water temperatures, and pool water treatments.*

*A professional with natatorium experience should be contacted for advice in these areas if you are lacking documentation or are unfamiliar with them.*

***A facility that is not maintained to these industry standards can accelerate the break-down of metal surfaces which can pose a significant safety hazard.***

### Facility Recommendations:

- Check water chlorine levels and ensure that they are not excessive (consult a professional if needed for acceptable chlorine concentrations).
- Do **\*NOT\*** allow free chlorine levels in the facility to become excessive. Excessive chlorine in a natatorium environment is an established factor in accelerating corrosion in all materials. Facilities that exceed industry standards place the structural integrity of the fixture(s) at greater risk. A professional with natatorium experience should be contacted for advice in the areas of maintenance and environmental controls if needed.
- Visually inspect pool area for any signs of corrosion or metal discoloration; this may be an indication of a facility-wide problem. Please note that the **ABSENCE** of visual signs does not mean that metal degradation is not possibly occurring. If signs are noted, immediately consult with a professional with natatorium experience. A complete review of the lighting fixture(s), including all mounting details, should be done.
- Monitor ambient temperatures at level of fixture(s) installation. Prolonged temperatures outside of listed operating range (-30°C to 40°C ambient environments for 92L/184L lamp power levels and -30°C to 30°C ambient environments for 130L/260L lamp power levels) can cause premature failure of light engine and possible voiding of warranty.
- Do **\*NOT\*** allow for pool area heating variations. This can contribute to chlorinated water condensing on lighting fixture(s) which can result in premature failure of the structural and/or electrical system(s). A professional with natatorium experience should be contacted for advice in the areas of maintenance and environmental controls if needed.

Failure to follow these maintenance recommendations may void your warranty and pose a significant safety hazard.



## MAINTENANCE, CARE, AND CLEANING GUIDE (continued)

**DISCONNECT POWER TO ALL CIRCUITS BEFORE SERVICING FIXTURE(S).  
QUALIFIED PERSONNEL SHOULD PERFORM ANY SERVICING OF FIXTURE(S).**

Fixture Recommendations:

- These lighting fixtures should receive regular inspection, cleaning, and if needed, maintenance. The frequency of the servicing will depend on the parameters set by the facility, but at a minimum should be performed semi-annually. More frequent servicing may be warranted due to facility conditions. A build-up of dirt, residue, or insects can indicate that more frequent servicing is warranted.
- All metal, glass, and plastic surfaces should be cleaned with a water & ammonia solution to remove any build-up. Use of other cleaning agents may damage the integrity of the fixture materials and should be done at the risk of the facilities services and/or management.
- The optical compartment should remain factory-sealed except for servicing or replacement of light engine components. When servicing or replacement is required, an inspection of all internal components for damage and/or corrosion should be completed. In addition, all installation instructions and precautions included with replacement light engine/components should be followed.
- Thoroughly inspect structural components for damage and/or corrosion. Some covers or brackets (such as pendant canopy cover) may require removal to complete this operation. All safety critical components - even those not directly supplied with fixture - should be inspected for any signs of damage and/or corrosion.
- Review all Facility Recommendations for additional fixture-related recommendations.

## CUSTOMER SERVICE

For technical assistance, call 1-800-4KENALL (1-800-453-6255). Please have the following information available:

- The name and location of your facility.
- The fixture part number and/or complete description (listed on fixture name plate and/or invoice).
- The production job number (listed on fixture name plate) or order number (listed on invoice).
- The date of purchase.

