

# MILLENIUM STRETCH™

## MLRS5 SERIES – VANITY

### PRODUCT FEATURES:

- » Surface wall mount – 5"×24", 36" and 48"
- » Extruded aluminum housing with decorative end caps
- » Low-profile –ADA compliant

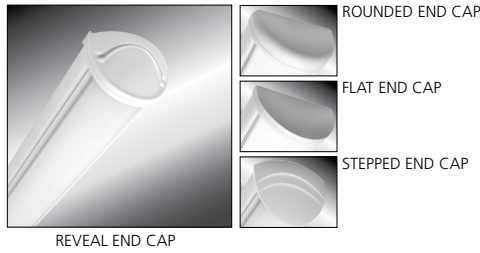

PROJECT INFORMATION	
Job Name	_____
Fixture Type	_____
Catalog Number	_____
Approved by	_____

### SPECIFICATIONS

**HOUSING:** Marine grade aluminum. Extruded body with die-cast end caps. Housing, with end caps, post assembly TGIC polyester powder coat finished – 5-step pre-treatment. See Ordering Information for standard, optional and custom finishes.

**REFLECTOR:** Full reflector/wire cover – 92% reflectivity.

**LENS:** UV-stabilized, high impact extruded clear acrylic or pearlescent polycarbonate (see ordering information). Smooth exterior, linear prismatic interior. Nominal thickness .156". Lens securely positioned in body channels and end caps. Lens locked in place with tamper-resistant stainless steel Torx® T-20 with center pin fasteners and sealed with closed cell gaskets.

**END CAPS:** Marine grade die-cast aluminum. Two styles available: Reveal and Stepped.

**SOCKETS:** Shock-resistant sockets with internal locking collar to ensure positive lamp retention.

**HARDWARE:** Four stainless steel, tamper-resistant Torx® T-20 with center pin fasteners secure lens in housing body's lens channel.

**ELECTRICAL:** **LED:** Available 3500K, 4000K and 5000K color temperatures, 82 CRI. 120-277VAC, 50/60Hz electrical input with serviceable high power factor electronic, constant-current driver (<20% THD, >0.95 PF). Standard 0-10V dimming with 3-100% range, maximum driver source of 250 µA. **LF:** Class P ballasts. Fluorescent electronic 120/277/347 and dual voltage ballasts high power factor.

**SENSOR & CONTROLS:** Optional sensor available with compatible third party controls. To see the full list of compatible controls, [click here](#).

**INSTALLATION:** Standard two-point (24" housing), four-point (36" and 48" housing) mounting recommended.

**WARRANTY:** limited ten (10) year warranty for LED Lamps.

**LISTINGS:** Listed to UL for Damp Location – horizontal and vertical wall mount.



### ORDERING INFORMATION (Ex: MLRS5V-48-F-MB-CIA-1-54-RS-1-DV-FS-9500)

Model	Length	End Cap	Finish	Lens	Lamp Qty	Lamp Type	Ballast/Driver Type	Circuit Qty	Voltage	Options
<b>MLRS5V</b>										
<b>Length</b>		<b>Lamp Type</b>		<b>Ballast/Driver Type</b>		<b>Options</b>				
24	2'	<b>2' Lengths</b>		<b>DCC</b>	Dimming Constant Current (LED Only)		<b>EL**</b> 500 Minimum Lumen Battery Pack (90 Minutes; 32°F Starting Temperature)			
36	3'	<b>14</b> F14T5		<b>IS</b>	Instant Start Electronic <10% THD (T8)		<b>PEL**</b> 1100 Minimum Lumen Battery Pack (90 Minutes; 32°F Starting Temperature)			
48	4'	<b>17</b> F17T8		<b>RS</b>	Rapid Start Electronic <10% THD (T8,T5,T5HO)		<b>CDF</b> Captive Diffuser Fasteners			
<b>End Caps</b>		<b>24</b> F24T5HO (120/277V)		<b>SB</b>	Specified Ballast		<b>FS</b> Single Fuse & Holder			
<b>F</b>	Flat	<b>3' Lengths</b>		<b>Circuit Quantity</b>		<b>PH</b> Phillips Head Fasteners				
<b>R</b>	Rounded	<b>21</b> F21T5		<b>1</b>	One		† n/a on 2' fixtures with EL option			
<b>RV</b>	Reveal	<b>25</b> F25T8		<b>2†</b>	Two		▲ 347V n/a with EL or PEL options.			
<b>SP</b>	Stepped	<b>39</b> F39T5HO (120/277V only)		<b>Voltage</b>		▼ 2' Fixtures have minimum 350-450 lumen battery pack. n/a with (2) T5HO lamps.				
<b>Finish</b>		<b>4' Lengths</b>		<b>120</b> 120 Volts		● n/a on 2' fixtures, 3' fixtures with T5 or T8 lamping, or with (2) T5HO lamps.				
<b>MW</b>	Matte White	<b>45L35K</b> 45 Watt 3500K LED		<b>277</b> 277 Volts		* n/a with LED Lamp Type				
<b>MB</b>	Matte Black	<b>45L40K</b> 45 Watt 4000K LED		<b>347▲</b> 347 Volts (Consult Factory)						
<b>LG</b>	Light Gray	<b>45L50K</b> 45 Watt 5000K LED		<b>DV</b> 120-277 Volts						
<b>CC</b>	Custom Color (Consult Factory)	<b>28</b> F28T5								
<b>Lens</b>		<b>32</b> F32T8								
<b>CIA*</b>	Clear High Impact Acrylic	<b>54</b> F54T5HO								
<b>PP</b>	Pearlescent Polycarbonate	<b>54A</b> F54T5HO amalgam								
<b>Lamp Quantity</b>										
<b>1</b>	One									
<b>2</b>	Two									



www.kenall.com | P: 800-4-Kenall | F: 262-891-9701 | 10200 55th Street Kenosha, Wisconsin 53144, USA

This product complies with the Buy American Act: manufactured in the United States with more than 50% of the component cost of US origin. It may be covered by patents found at www.kenall.com/patents. Content of specification sheets is subject to change; please consult www.kenall.com for current product details. ©2022 Kenall Mfg. Co.

A brand of **legrand**

# MILLENIUM STRETCH™

## MLR55 SERIES – VANITY

### PERFORMANCE

Lamp Type	Initial Delivered Lumens		Input Power (W)	Drive Current (mA)	Estd. L70 LED Life (Hrs)
	@ 25°C	Efficacy (lm/W)			
45L35K	4246	85	50	94	150,000
45L40K	4526	90	50	94	150,000
45L50K	4707	94	50	94	150,000

Displayed information is for selected luminaires only. Additional wattages and color temperatures are also available. Visit [www.kenall.com](http://www.kenall.com) for additional information.

Model: MLR55-48-F-MW-PP-1-45L40K-DCC-1-DV

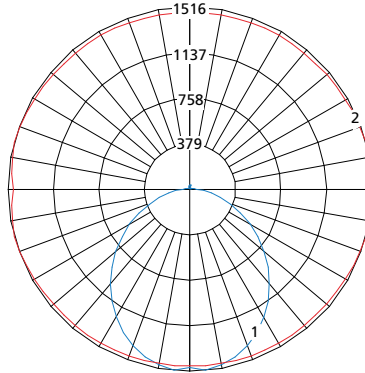

Maximum Candela = 1241 Located At Horizontal Angle = 15, Vertical Angle = 5

- 1 - Vertical Plane Through Horizontal Angles (15-195) (Through Max. Cd.)
- 2 - Horizontal Cone Through Vertical Angle (5) (Through Max. Cd.)

### DIMENSIONAL DATA

#### CROSS SECTION/DETAILS

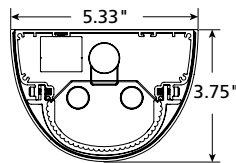

#### MOUNTING HOLES

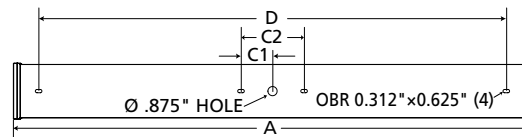

#### Nominal Two Foot Fixture Legend

LMP	End Cap	A	B	C1	C2	D
T8	SP	28.13	22.25	N/A	N/A	20.48
T8	RV	27.67	22.25	N/A	N/A	20.48
T5	SP	26.55	20.67	N/A	N/A	18.90
T5	RV	26.09	20.67	N/A	N/A	18.90

#### Nominal Three Foot Fixture Legend

LMP	End Cap	A	B	C1	C2	D
T8	SP	40.13	34.25	3.00	6.00	32.48
T8	RV	39.67	34.25	3.00	6.00	32.48
T5	SP	38.36	32.48	2.95	5.91	30.71
T5	RV	37.90	32.48	2.95	5.91	30.71

#### Nominal Three Foot Fixture Legend

LMP	End Cap	A	B	C1	C2	D
T8	SP	52.13	46.25	3.00	6.00	44.48
T8	RV	51.67	46.25	3.00	6.00	44.48
T5	SP	50.17	44.29	2.95	5.91	42.52
T5	RV	49.71	44.29	2.95	5.91	42.52



[www.kenall.com](http://www.kenall.com) | P: 800-4-Kenall | F: 262-891-9701 | 10200 55th Street Kenosha, Wisconsin 53144, USA

This product complies with the Buy American Act: manufactured in the United States with more than 50% of the component cost of US origin. It may be covered by patents found at [www.kenall.com/patents](http://www.kenall.com/patents). Content of specification sheets is subject to change; please consult [www.kenall.com](http://www.kenall.com) for current product details. ©2022 Kenall Mfg. Co.

A brand of Legrand