

# NOVA II™

## N1048 SERIES (7200)

### PRODUCT FEATURES:

- » Surface mount – ceiling or wall; nominal 10" x 48"
- » ADA Compliant
- » 16-gauge cold rolled steel baseplate with six-point mounting
- » One-piece seam wraparound polycarbonate lens



### PROJECT INFORMATION

Job Name \_\_\_\_\_

Fixture Type \_\_\_\_\_

Catalog Number \_\_\_\_\_

Approved by \_\_\_\_\_

### SPECIFICATIONS

**BASEPLATE:** 16-gauge CRS. Baseplate provided with six-point mounting holes and one wireway hole. TGIC polyester powder coat – 5-stage pre-treatment. Salt spray test: 1,000 hours; Reflectance: 92%.

**LENS:** One-piece wraparound lens with eight alignment security tabs for baseplate engagement. UV-stabilized, high impact, virgin injection molded pearlescent prismatic polycarbonate. Nominal thickness .125".

**ELECTRICAL:** LED; Available 3000K, 3500K, 4000K and 5000K color temperatures, 82 CRI. 120-277VAC, or 347VAC 50/60Hz electrical input with serviceable high power factor electronic, constant-current driver (<20% THD, >0.95 PF). Standard 0-10V dimming with 1-100% range and dim-to-dark capabilities (non dim-to-dark with 347V); 330µA max. source current. Optional embedded microwave motion sensor (MS) has factory default settings of 20 minute time out, dims down to 30%. LE: Class P ballasts. Fluorescent electronic 120/277/347 and dual voltage ballasts high power factor. 0°F min. starting temperature standard.

**SOCKETS:** Shock-resistant sockets with internal locking collar to ensure positive lamp retention.

**GASKET:** Die-cut closed cell neoprene gasket seals lens/housing to mounting surface.

**HARDWARE:** Four stainless steel Torx® T-20 with center pin fasteners secure lens/housing to baseplate.

**INSTALLATION:** Six-point mounting required for Peace of Mind Guarantee®. "Twist-out" sections, with gaskets, permit 1/2" conduit access on each end without special adapter.

**PHOTOMETRICS:** For photometric information, go to [www.kenall.com](http://www.kenall.com).

**WARRANTY:** Limited five (5) year warranty. [Peace of Mind Guarantee against breakage.](#)

**LISTINGS:** Luminaire is certified to UL Standards by Intertek Testing Laboratory for Wet Locations - Covered Ceilings. Suitable for installation into -40°C to 40°C ambient environments, unless otherwise noted. Luminaire tested to an IK10 impact protection rating per IEC 60068-2-75:1997-08.



### ORDERING INFORMATION (Ex: N1048-P-1-67L40K-DCC-DV)

Model	Lens Type	Lamp Qty	Lamp Type	Ballast/Driver	Ballast Qty	Voltage	Options	Accessories
<b>N1048</b>	<b>P</b>							
	<b>Lens Type</b>		<b>Lamp Type</b>			<b>Voltage</b>		
	<b>P</b> Pearlescent		<b>45L30K</b> 45 Watt 3000K LED			<b>DV</b> 120-277 Volts		
			<b>45L35K</b> 45 Watt 3500K LED			<b>347</b> 347 Volts		
	<b>Lamp Quantity</b>		<b>45L40K</b> 45 Watt 4000K LED				<b>Options</b>	
	<b>1</b> One (LED only)		<b>45L50K</b> 45 Watt 5000K LED				<b>LEL</b> Integral 8.4W Emergency Battery Backup	
	<b>2‡</b> Two Lamps		<b>67L30K</b> 67 Watt 3000K LED				(45L max., 0°C minimum operating temperature, n/a with 347V)	
	<b>3‡</b> Three Lamps		<b>67L35K</b> 67 Watt 3500K LED				<b>EL‡</b> Standard Lumen Battery Pack	
	<b>4‡</b> Four Lamps		<b>67L40K</b> 67 Watt 4000K LED				(32°F, one-lamp operation; n/a with 347V)	
			<b>67L50K</b> 67 Watt 5000K LED				<b>FS</b> Single Fuse & Holder	
			<b>90L30K</b> 90 Watt 3000K LED				<b>MS4</b> Four Maximum Security Flange Retainer Clips and Fasteners	
			<b>90L35K</b> 90 Watt 3500K LED				<b>MS6</b> Six Maximum Security Flange Retainer Clips and Fasteners	
			<b>90L40K</b> 90 Watt 4000K LED				<b>MS</b> Motion Sensor (LED only, n/a 347V)	
			<b>90L50K</b> 90 Watt 5000K LED				<b>NLW•</b> 2700K White LED Night Light	
			<b>28</b> F28T5				<b>NLA•</b> Amber LED Night Light	
			<b>32</b> F32T8					
			<b>54</b> F54T5HO (Two lamps only)					
			<b>Ballast/Driver Type</b>				<b>Accessories</b>	
			<b>DCC</b> Dimming Constant Current LED Driver (LED only)				<b>CM</b> Corner Mount Adapter (682) Damp Locations only	
			<b>IS</b> Instant Start Electronic <10% THD (T8)				<b>SA</b> Surface Adapter (7200A)	
			<b>RS</b> Rapid Start Electronic <10% THD (T8, T5)					
			<b>SB</b> Specified Ballast					
			<b>Ballast Quantity (n/a with LED)</b>					
			<b>1</b> One					
			<b>2</b> Two					



www.kenall.com | P: 800-4-Kenall | F: 262-891-9700 | 10200 55th Street Kenosha, Wisconsin 53144, USA  
 This product is able to comply with the latest domestic preference legislation, such as the Buy American Act (BAA), Trade Agreement Act (TAA), Build America, Buy America Act (BABA), and others. It may be covered by patents found at [www.kenall.com/patents](http://www.kenall.com/patents). Content of specification sheets is subject to change; please consult [www.kenall.com](http://www.kenall.com) for current product details. ©2024 Kenall Mfg. Co.

A brand of **legrand**

# NOVA II™

## N1048 SERIES (7200)

### PERFORMANCE

Model	Lamp Power	Initial Delivered Lumens, By Lamp Color (lm)				Efficacy (lm/W)	Input Power (W)	Estd. L70 LED Life (hrs)
		30K8	35K8	40K8	50K8			
N1048	45L	5,072	5,229	5,407	5,624	104 - 115	49	100,000
	67L	7,829	8,071	8,347	8,681	112 - 124	70	100,000
	90L	9,982	10,291	10,642	11,068	107 - 119	93	80,000

Displayed information is for selected luminaires only. Additional wattages and color temperatures are also available. Visit [www.kenall.com](http://www.kenall.com) for additional information.

Model: N1048-C-1-90L40K-DCC-DV

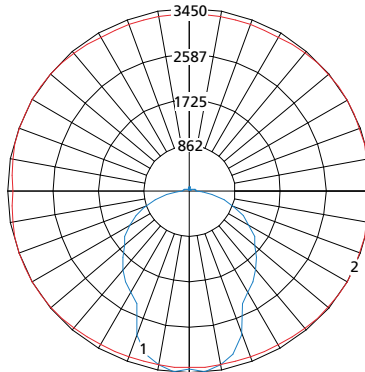

Maximum Candela = 3450 Located At Horizontal Angle = 30, Vertical Angle = 5

- 1 - Vertical Plane Through Horizontal Angles (30-210) (Through Max. Cd.)
- 2 - Horizontal Cone Through Vertical Angle (5) (Through Max. Cd.)

### DIMENSIONAL DATA

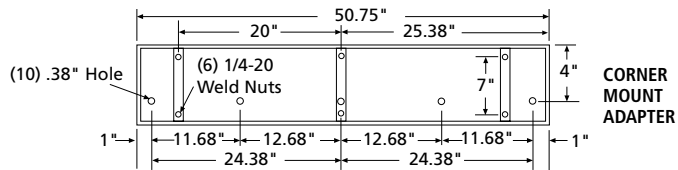
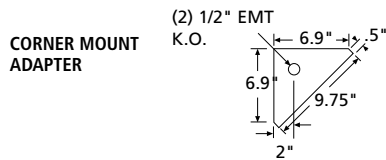
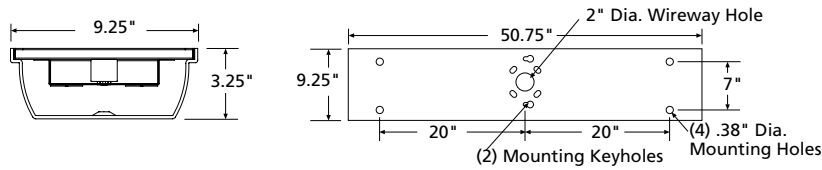

[www.kenall.com](http://www.kenall.com) | P: 800-4-Kenall | F: 262-891-9700 | 10200 55th Street Kenosha, Wisconsin 53144, USA  
 This product is able to comply with the latest domestic preference legislation, such as the Buy American Act (BAA), Trade Agreement Act (TAA), Build America, Buy America Act (BABA), and others. It may be covered by patents found at [www.kenall.com/patents](http://www.kenall.com/patents). Content of specification sheets is subject to change; please consult [www.kenall.com](http://www.kenall.com) for current product details. ©2024 Kenall Mfg. Co.

A brand of **legrand**