

# NOVA II™

## N1048 SERIES (7200) – 24 HOUR SHIP PROGRAM

### PRODUCT FEATURES:

- » Surface mount – ceiling or wall; nominal 10" x48"
- » ADA Compliant
- » 16-gauge cold rolled steel baseplate with six-point mounting
- » One-piece seam wraparound polycarbonate lens



### PROJECT INFORMATION

Job Name \_\_\_\_\_

Fixture Type \_\_\_\_\_

Catalog Number \_\_\_\_\_

Approved by \_\_\_\_\_

### SPECIFICATIONS

**BASEPLATE:** 16-gauge CRS. Baseplate provided with six-point mounting holes and one wireway hole. TGIC polyester powder coat – 5-stage pre-treatment. Salt spray test: 1,000 hours; Reflectance: 92%.

**LENS:** One-piece wraparound lens with eight alignment security tabs for baseplate engagement. UV-stabilized, high impact, virgin injection molded clear prismatic polycarbonate. Nominal thickness .125".

**ELECTRICAL:** Available 4000K color temperature, 82 CRI. 120-277VAC, 50/60Hz electrical input with serviceable high power factor electronic, constant-current driver (<20% THD, >0.95 PF). Standard 0-10V dimming with 3-100% range.

**SOCKETS:** Shock-resistant sockets with internal locking collar to ensure positive lamp retention.

**GASKET:** Die-cut closed cell neoprene gasket seals lens/housing to mounting surface.

**HARDWARE:** Two stainless steel Torx® with center pin fasteners secure lens/housing to baseplate.

**INSTALLATION:** Six-point mounting required for Peace of Mind Guarantee®. "Twist-out" sections, with gaskets, permit 1/2" conduit access on each end without special adapter.

**PHOTOMETRICS:** For photometric information, go to [www.kenall.com](http://www.kenall.com).

**WARRANTY:** Limited five (5) year warranty.

**LISTINGS:** UL and CUL listed for Wet Location – covered ceilings only.



### ORDERING INFORMATION (Ex: N1048-P-67L40K-DCC-DV)

Model	Lens Type	Lamp Type	Driver Type	Voltage
<b>N1048</b>	<b>P</b>	<b>67L40K</b>	<b>DCC</b>	<b>DV</b>
	<b>Lens Type</b> P Pearlescent	<b>Lamp Type</b> 67L40K 67 Watt 4000K LED	<b>Driver Type</b> DCC Dimming Constant Current LED Driver	<b>Voltage</b> DV 120-277 Volts



[www.kenall.com](http://www.kenall.com)

P: 800-4-Kenall

F: 262-891-9701

10200 55th Street Kenosha, Wisconsin 53144

When you see this image, you will know the Kenall product shown or described is designed and manufactured in the USA with components purchased from US suppliers, and meets the Buy American requirements under the ARRA. Kenall has not determined the origin of its domestically purchased components or the subcomponents thereof. May be covered by patents found at [www.kenall.com/patents](http://www.kenall.com/patents). Content of specification sheets is subject to change; please consult [www.kenall.com](http://www.kenall.com) for current product details. © 2015 Kenall Mfg. Co. All rights reserved.

N1048-041615

# NOVA II™

## N1048 SERIES (7200)

PERFORMANCE	Initial Delivered Lumens		Input Power (W)	Drive Current (mA)	Estd. L70 LED Life (Hrs)	
	Lamp Type	@ 25°C (lm)				Efficacy (lm/W)
	67L40K	7116	98	72	66	80,000

Displayed information is for selected luminaires only. Additional wattages and color temperatures are also available. Visit [www.kenall.com](http://www.kenall.com) for additional information.

Model: N1048-P-67L40K-DCC-DV

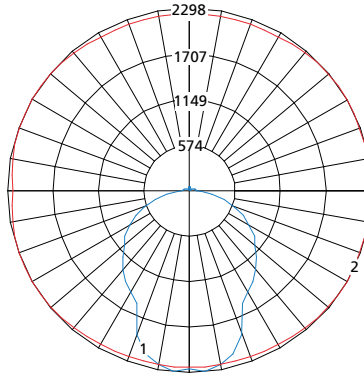

Maximum Candela = 2298 Located At Horizontal Angle = 30, Vertical Angle = 5

- 1 - Vertical Plane Through Horizontal Angles (30-210) (Through Max. Cd.)
- 2 - Horizontal Cone Through Vertical Angle (5) (Through Max. Cd.)

### DIMENSIONAL DATA

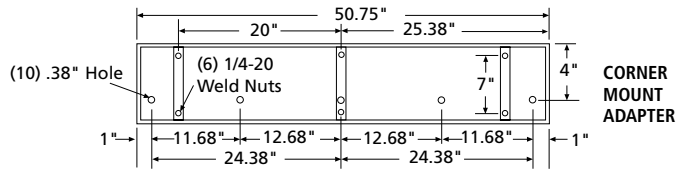
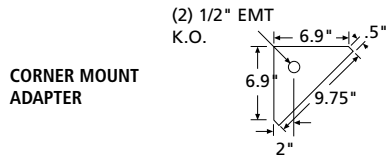
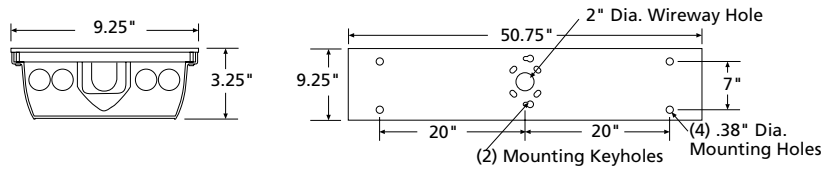

[www.kenall.com](http://www.kenall.com)

P: 800-4-Kenall

F: 262-891-9701

10200 55th Street Kenosha, Wisconsin 53144

When you see this image, you will know the Kenall product shown or described is designed and manufactured in the USA with components purchased from US suppliers, and meets the Buy American requirements under the ARRA. Kenall has not determined the origin of its domestically purchased components or the subcomponents thereof. May be covered by patents found at [www.kenall.com/patents](http://www.kenall.com/patents). Content of specification sheets is subject to change; please consult [www.kenall.com](http://www.kenall.com) for current product details. © 2015 Kenall Mfg. Co. All rights reserved.

N1048-041615